

INSTALLATION OF ELEVATOR (IMUG Campus)

Eight person passenger elevator with the following specifications will be installed at IMUG

Specifications:

- Entrance with light (daylight)
- Half mirror
- Half wood accent finish
- Hard vinyl flooring

ABC: P 2,500,000.00

Equipment:

- K2 Light
- Travel
- Safety

Electrical:

- Inverter
- All safety
- Sensors
- Alarm for overloading

Horizontal Dimensions:

- Rated Capacity: 800
- Rated speed: 1.0, 1.5
- Door type: CO
- Entrance width: 80"
- Car interior clearance: 48"
- Counter weight clearance: 48"

Vertical Dimensions:

- Rated speed: 1.0
- Rated capacity: 800
- Maximum travel: 200'
- Maximum number of floors: 10
- Maximum number of stops: 10
- Maximum travel time: 10 min
- Maximum floor-to-floor: 10'

Work items:

- Fabrication of Casing
- Fixing of concrete base
- Other masonry works
- Standard quantity, all

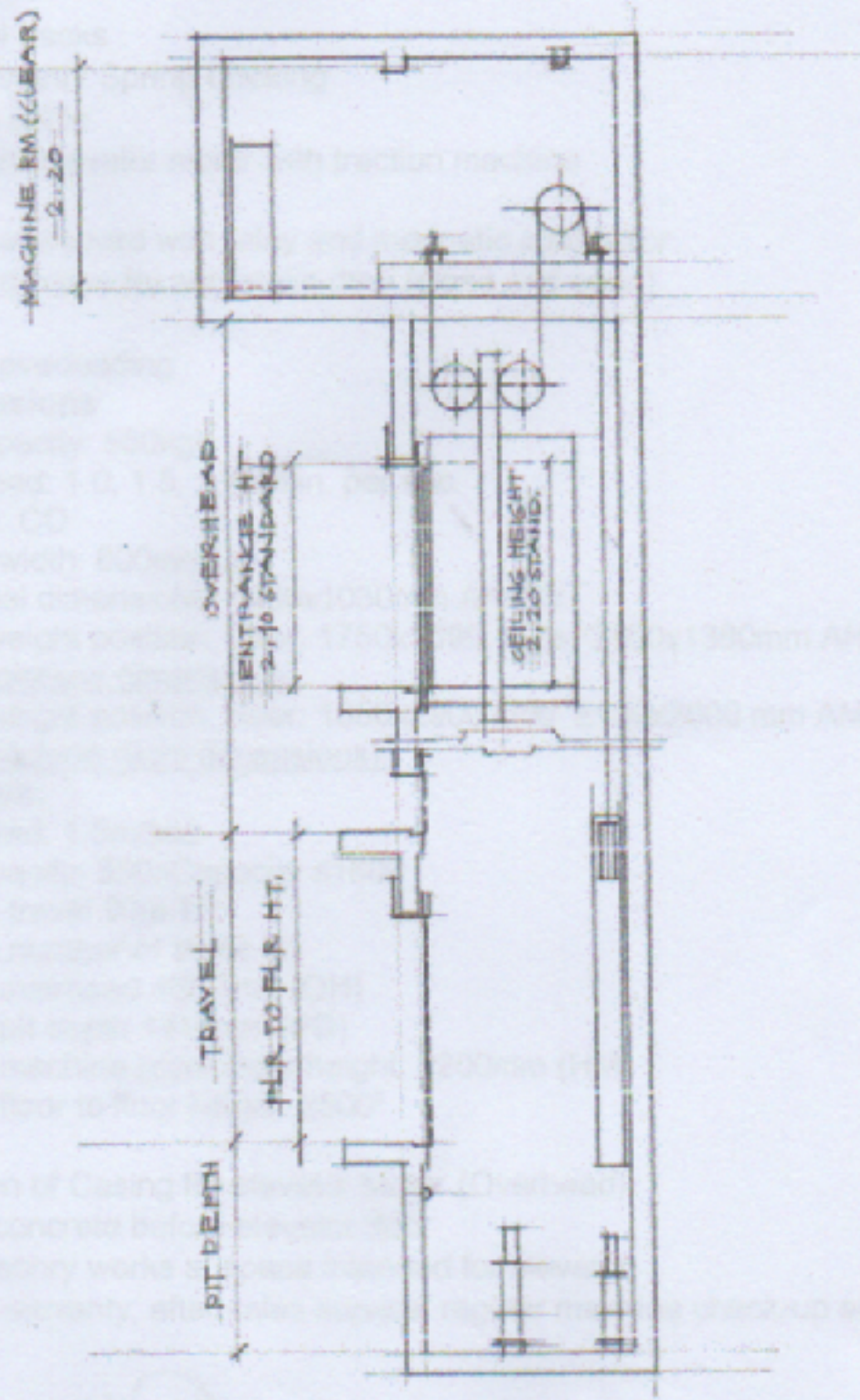

SECTION
A C S

NOTE:
 • HOISTWAY SECTION FOR COUNTERWEIGHT SIDE DROP IS SLIGHTLY DIFF. FR. FIGURE
 • LAYOUT DIFFERS DEPENDING ON CAPACITY

PREPARED	END USER	ENDORSED:	RECAPP.	APPROVED:	PROJ. TITLE:	SHEET#
SBBAYOT, Jr.	YML Delacruz MC DELACRUZ	R. B. CUBILLA	HO GARCIA	HD ROBLES	INST. OF ELEV. FOR CVSU CVSU IMUG CAMPUS	1