



Republic of the Philippines
CAVITE STATE UNIVERSITY
Don Severino de las Alas Campus

Indang, Cavite, Philippines
☎ (046) 4150-010 / 📠 (046) 4150-0013 loc 203
www.cvsu.edu.ph

INVITATION TO SUBMIT QUOTATION
Landscaping of Graduate School Facilities (By Straight Contract)

1. The Cavite State University (CvSU) invites interested firms/supplier to submit quotation for the project “**Landscaping of Graduate School Facilities (By Straight Contract)**” with an Approved Budget for the Contract (ABC) **Six Hundred Ten Thousand Eight Hundred Fifty-Six Pesos and 27/100 Only (PhP 610,856.27)**. Quotation received in excess of the ABC shall be automatically rejected at the opening.

Item No.	Quantity	Unit	Description	Unit Cost	Total Cost
1	1	Lot	Landscaping of Graduate School Facilities (By Straight Contract)	610,856.27	610,856.27
TOTAL AMOUNT					610,856.27

2. Delivery Period: ____ calendar days from the receipt of P.O.
3. Price quotations must be valid for a period of sixty (60) calendar days from date of submission and shall include all taxes, duties and/or levies payable. Bidders shall also indicate the brand and model of the items being offered.
4. Warranty shall be for a period of six (6) months for supplies and materials. Warranty for equipment must not be less than one (1) year from the date of acceptance and shall be accompanied with Warranty Certificate.
5. The quotation must be submitted to the Procurement Office through mail, fax or email at the contact details listed below **on or before 5:00 PM of March 16, 2023**.

Address : Procurement Office, Administration Building
Cavite State University
Indang, Cavite
E-mail : procurementoffice@cvsu.edu.ph / rfqmain@cvsu.edu.ph
Telefax : (046) 862-0852

6. The CvSU reserves the right to reject any or all quotations and/or proposals and waive any formalities/informalities therein and to accept such bids it may consider as most advantageous to the agency and to the government. CvSU neither assumes any obligation for whatsoever losses that may be incurred in the preparation of bids, nor does it guarantee that an award will be made.

ROSELYN M. MARANAN
BAC Secretary, Goods and Consulting Services



Republic of the Philippines
CAVITE STATE UNIVERSITY
 Don Severino delas Alas Campus
 Indang, Cavite

BILL OF QUANTITIES

NAME OF PROJECT: LANDSCAPING OF GRADUATE SCHOOL (BY STRAIGHT CONTRACT)					
ABC: ₱ 610,856.27				Bill of Quantities	
COLLEGE/UNIT/CAMPUS: GRADUATE SCHOOL MAIN CAMPUS					
Item No.	Description	Unit	Quantity	Unit Price (Pesos)	Amount (Pesos)
I	Earthworks (Pesos _____ _____ and _____ centavos)				
II	Concrete and Masonry Works (Pesos _____ _____ and _____ centavos)				
III	Carpentry Works (Pesos _____ _____ and _____ centavos)				
IV	Miscellaneous Works (Pesos _____ _____ and _____ centavos)				
GRAND TOTAL					_____
Write grand total in words			_____ _____ _____		

Submitted by: _____ Date: _____

Name of Bidder/Bidder's Representative: _____

Position: _____

Construction Company/Contractor: _____

LANDSCAPING OF G.S. FACILITIES

1. The project should be finished for 30 calendar days.
2. Actual site inspection is a must.

A. Technical Description

I. Earthworks

A. Excavation / backfilling / clearing

1. This work includes excavation for wall footing and concrete gutter.
2. The area should be cleared/cleaned before and after the construction work at least twenty meters away from the building line. Unusable used formworks, excessive soil fill and other unwanted debris of construction works should be disposed properly.

II. Concrete and Masonry Works

1. Concrete works include wall footing, ramp, stair, gutter, driveway and walk.
 - a. Driveway = 40.0 mtrs.
 - b. Walk (to museum) = 26.0 mtrs.
 - c. Perimeter walk = 24.0 mtrs.
 - d. Concrete gutter = 160.0 mtrs.
 - e. Wall footing = 70.0 mtrs
2. Strength of concrete to be adopted shall be **3,000 psi**
3. **Concrete works should be stamp cement finished.**
4. Provide necessary tools and equipment needed for concrete works.
5. Used deformed bar grade 33 for wall footing, ramp, stair and walk.
6. Installation of CHB reinforced with 10 mm 0 deformed bar spaced at 0.60 m.
 - a. CHB 4" zocalo wall for ramp, stair and walk.
7. Masonry works should be plastered plain cement.
8. Provide necessary tools and equipment needed for steel works.

III. Carpentry Works

1. Provide formworks

IV. Miscellaneous Works

1. Stainless Railing (Ramp)
 - Provide 1.5 mm thick stainless tubing for railings. Use 2" & 1" tubing.

V. See plan for details and extent of work.

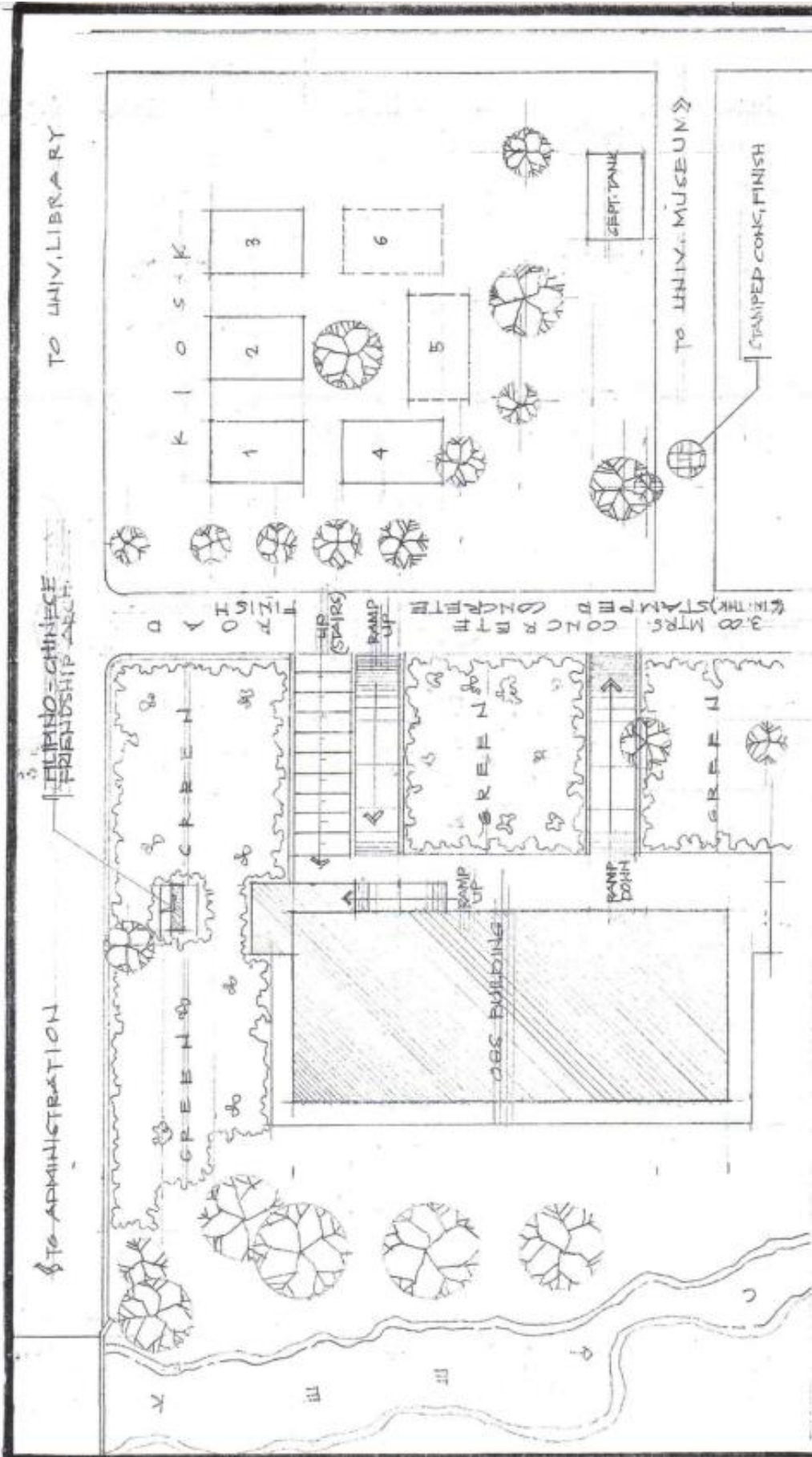

SITE DEVELOPMENT PLAN
SCALE: 1:250 MTS.

PREPARED: <i>[Signature]</i>	ENDORSED: <i>[Signature]</i>	APPROVED: <i>[Signature]</i>	PROJECT TITLE: LANDSCAPING OF G.S. FACILITIES.	AGENCY: CVSU	SHEET: 1
PREPARED: <i>[Signature]</i>	ENDORSED: <i>[Signature]</i>	APPROVED: <i>[Signature]</i>	PROJECT TITLE: LANDSCAPING OF G.S. FACILITIES.	AGENCY: CVSU	SHEET: 1

0.11478 - 1/16"

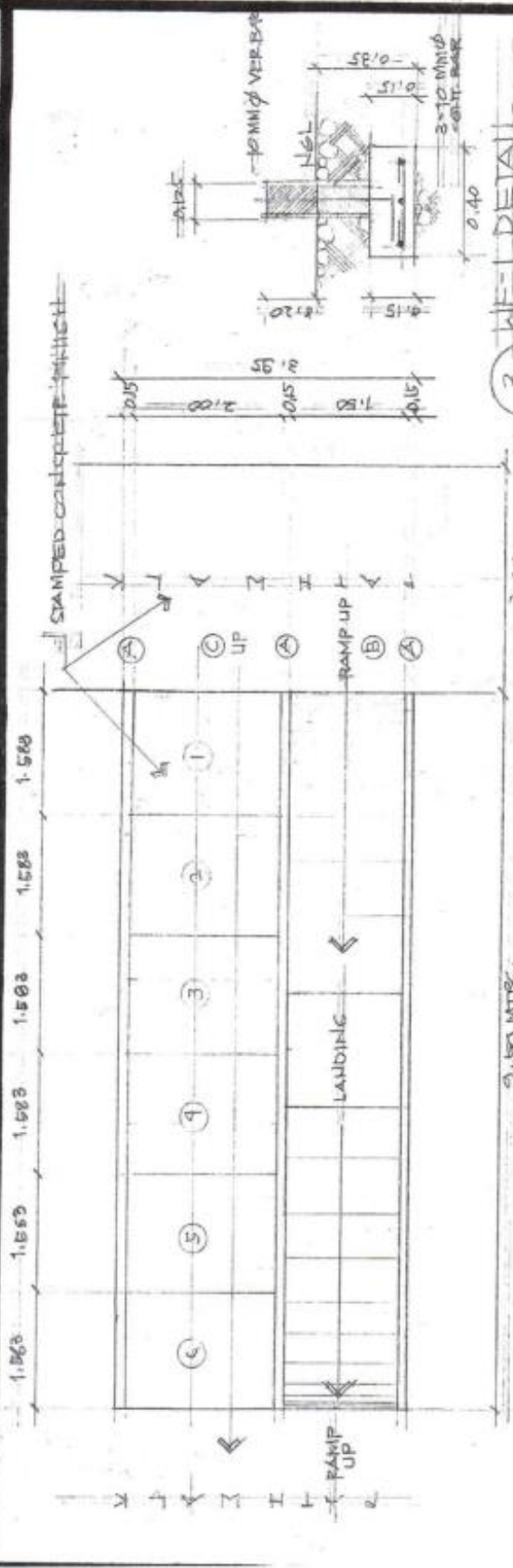

1 SPOT DETAIL
2 SCALE 1/175 MTR.

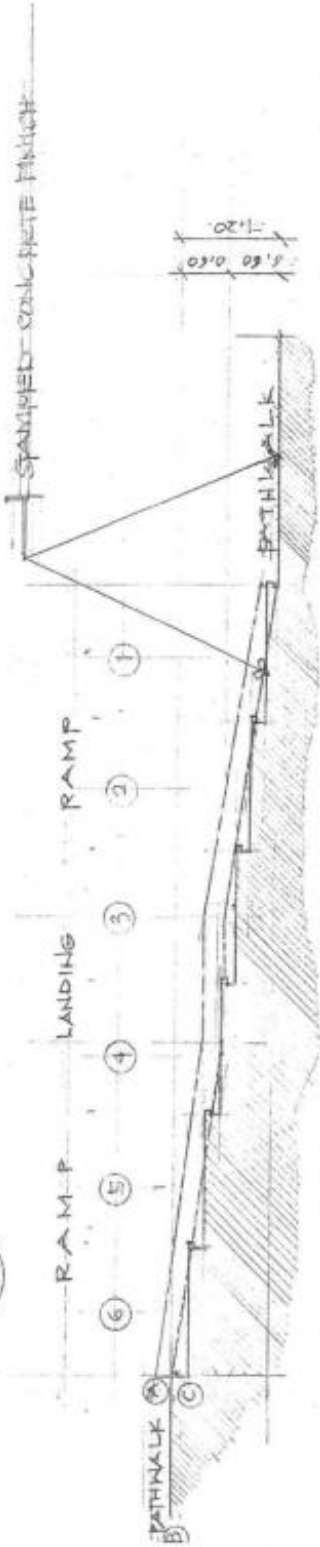

2 CROSS SECTION
3 SCALE 1/175 MTR.

PREPARED	IND. USER:	APPROVED:	PROJECT TITLE:	1. AGENCY	SHEET#
	RIBAHITA		LANDSCAPING OF G.S. FACILITIES.	CYSU	2