



Republic of the Philippines
CAVITE STATE UNIVERSITY
Don Severino de las Alas Campus
Indang, Cavite, Philippines
☎ (046) 889-6373
www.cvsu.edu.ph

INVITATION TO SUBMIT QUOTATION
Supply, Delivery and Installation of Office Furniture and Fixtures for Supply Office

1. The Cavite State University (CvSU) invites interested firms/supplier to submit quotation for the project "**Supply, Delivery and Installation of Office Furniture and Fixtures for Supply Office**" with an Approved Budget for the Contract (ABC) of **Two Hundred Thirteen Thousand Pesos Only (PhP 213,000.00)**. Quotation received in excess of the ABC shall be automatically rejected at the opening.

Item No.	Unit	Description	Quantity	Unit Cost	Total Cost
1.	unit	Cabinet Bolt (see attached specification)	1	78,000.00	78,000.00
2.	unit	Steel Cabinet 4 drawers, Heavy Duty (52"H x 18-1/2"W x 22"D) Gray	2	11,000.00	22,000.00
3.	unit	Lateral cabinet 3 layers, powder coated, frost gray (90wx45dx106h)	1	13,000.00	13,000.00
4.	lot	Office Partition (see attached specification and lay-out)	1	100,000.00	100,000.00
TOTAL AMOUNT					213,000.00

2. Delivery Period: ____ calendar days from the receipt of P.O.
3. Price quotations must be valid for a period of sixty (60) calendar days from date of submission and shall include all taxes, duties and/or levies payable. Bidders shall also indicate the brand and model of the items being offered.
4. Warranty shall be for a period of six (6) months for supplies and materials. Warranty for equipment must not be less than one (1) year from the date of acceptance and shall be accompanied with Warranty Certificate.
5. The quotation must be submitted to the Procurement Office through mail, fax or email at the contact details listed below **on or before 5:00 PM of February 6, 2025**.

Address : Procurement Office, Administration Building
Cavite State University
Indang, Cavite
E-mail : procurementoffice@cvsu.edu.ph / rfqmain@cvsu.edu.ph
Telefax : (046) 889-6373

6. The CvSU reserves the right to reject any or all quotations and/or proposals and waive any formalities/informalities therein and to accept such bids it may consider as most advantageous to the agency and to the government. CvSU neither assumes any obligation for whatsoever losses that may be incurred in the preparation of bids, nor does it guarantee that an award will be made.



ROSELYN M. MARANAN
BAC Secretary, Goods and Consulting Services

Cabinet Bolt Specifications:

IPC 3 WITH CASH LOCKER			
NET DOOR THICKNESS	1-1/2" SLAB , 4-1/4" NET DOOR THICKNESS		
OVERALL DOOR THICKNESS	4 1/4" (handle not included), 5 3/4" (handle included)		
OVERALL DIMENSIONS			
	HEIGHT	WIDTH	DEPTH
EXTERIOR	59"	20"	31-5/8"
INTERIOR	51-3/16"	16-1/2"	24-7/8"
DRAWER HEAD	12 9/16"	18 1/4"	2 3/4"
DRAWER BODY	4 5/8"	15 5/16"	24"
FRONT DRAWER	14 7/16"	20"	1 1/2" or 4 1/4"
PROTECTION			
LOCK	The Locking system is controlled by one set of three tumbler key- changing combination locksets, capable of 1,000,000 combination changes.		
INSULATION	This cash safe is protected by by SuperCF 160, a proprietary fire and drill resistant material developed through intensive research and development.		
FINISH	Painted/textured dark gray		
NET WEIGHT	520 KG		

ITEM NO.	DESCRIPTION	QTY/UNIT	UNIT PRICE	TOTAL AMT.
1	Laminated Partition - 42mm thickness - aluminum endtrims - 150(h)X40(w) cm.	1 pc	P 7,250.00	P 7,250.00
2	Laminated Partition - 42mm thickness - aluminum endtrims - 115(h)X110(w) cm.	1 pc	P 14,250.00	P 14,250.00
3	Laminated Partition - 42mm thickness - aluminum endtrims - 115(h)X60(w) cm.	1 pc	P 8,000.00	P 8,000.00
4	Freestanding Table - laminated woodgrain finish - full modesty - 140(w)X80(d)X74(h) cm.	1 pc	P 12,500.00	P 12,500.00
5	Table top - laminated woodgrain - 150(l)X30(w)	1 pc	P 3,500.00	P 3,500.00
6	Table legs, chrome	2 pcs	P 1,250.00	P 2,500.00
7	Table top - laminated woodgrain - 110(l)X60(w)	1 pc	P 3,500.00	P 3,500.00
8	Table riser, 2 sides open - 50(l)X30(w)X20(h) cm.	1 pc	P 3,500.00	P 3,500.00
	Partition Add-On From 115(h) to 150(h) cm - 2pcs T42-115150L to T42-150150L - 2pcs T42-115150LG to T42-150150LG - 1pcT42-11545L to T42-15045L - 1pcT42-11545LG to T42-15045LG	1 lot	P 35,000.00	P 35,000.00
	Dismantling, Re-Installation & Hauling	1 lot	P 10,000.00	P 10,000.00
TOTAL				P 100,000.00

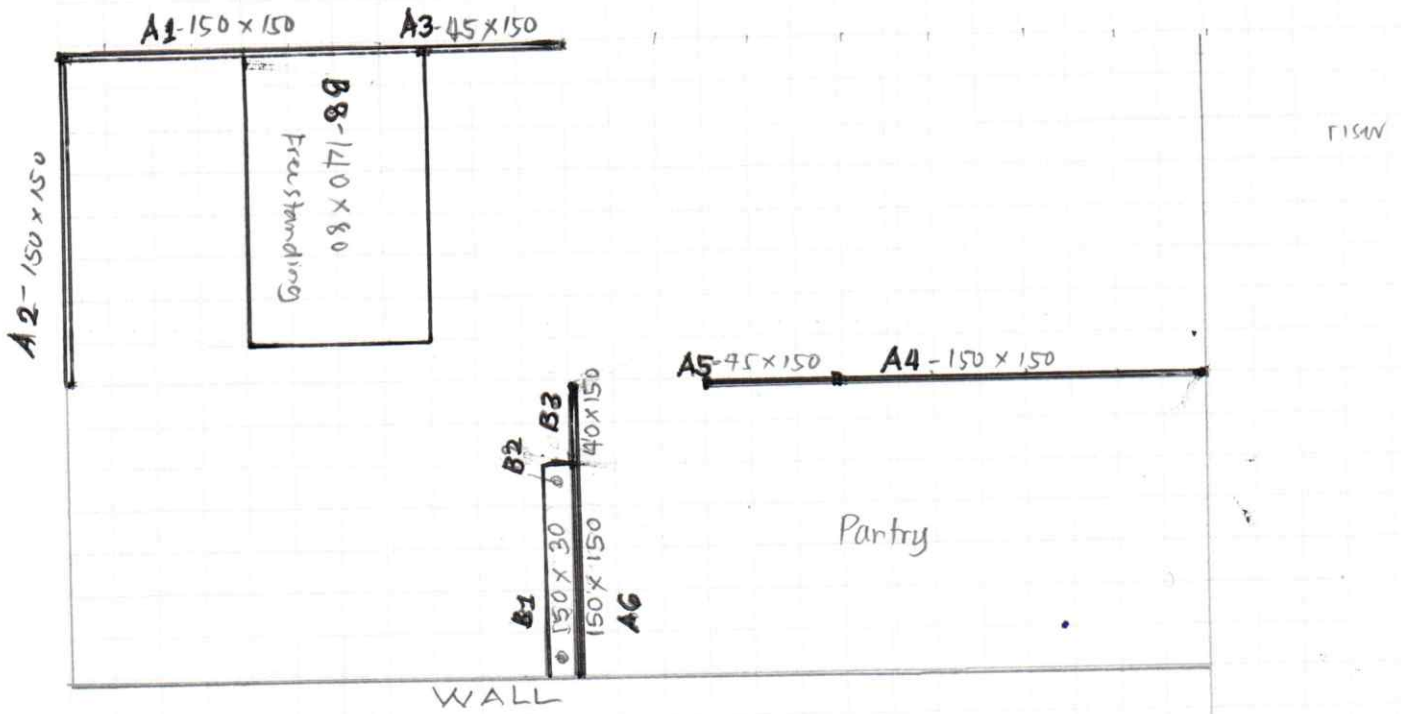
Back



Front

